

16mm TOP WITH 10mm
SIDES AND BOTTOM HOT DIP
GALVANIZED STEEL CULVERT

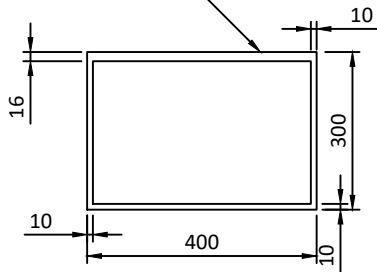

PROVIDE SILASTIC SEALANT
(OR EQUIVALENT)
BETWEEN CULVERTS

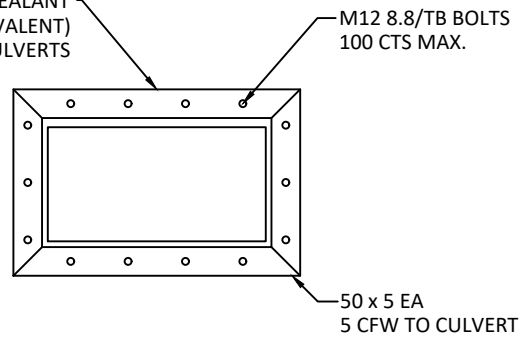

STEEL BOX CULVERT DETAIL

SCALE NTS

- NOTES:
1. ALL STEEL MEMBERS SHALL BE HOT DIP GALVANISED AND 300+ GRADE STEEL.
 2. ALL STEELWORK SHALL COMPLY TO AS4100, AS4600 & AS 3828.



DRAWING FILE
LOCATION
T:\AUTOCAD BLOCKS\2010+STEEL
BOX CULVERT (M1580).dwg

COORDINATOR
DESIGN
B.MORIAS
19.01.23

EDITED
G.FERTEKLIS
19.01.23
DRAWN
G.FERTEKLIS
19.01.23
DESIGNED
CCS
2016

STANDARD DETAIL

STEEL BOX CULVERT DETAIL

SCALE AS SHOWN

CITY OF CHARLES STURT

SHEET
1 of 1

TRIM No.
23/12538

DRAWING No.
M1580