

PLAN

CONSTRUCTION SETOUT POINT (CENTRE OF PIT)

600Ø TERRA FIRMA E400 PIT LID BOLTED TO COVER SLAB. LID TO HAVE LOCKED COVER.

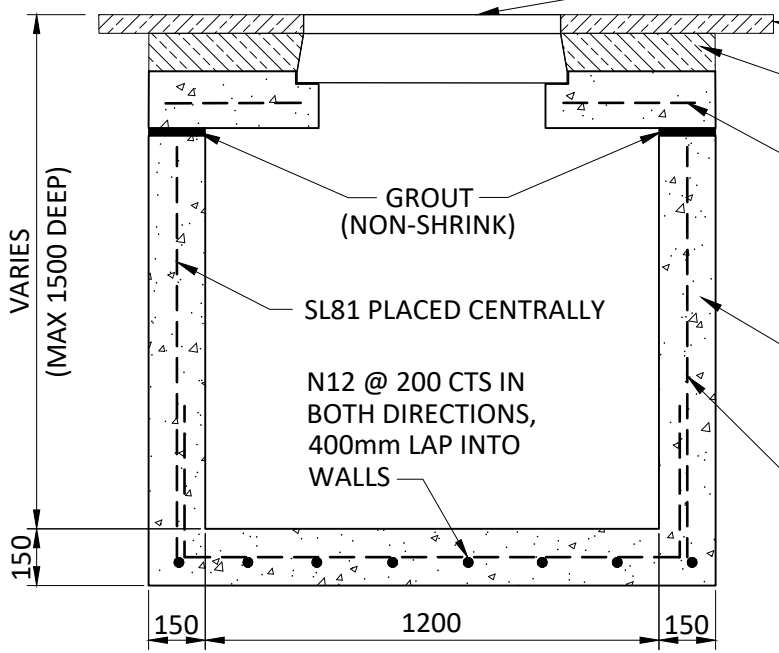

SECTION A
SCALE 1:20

50mm AC10M WEARING COURSE
2 LAYERS OF AC10M TO OUTER EDGE OF PIT (TYPICAL)
150mm THICK COVER SLAB WITH 32MPa CONCRETE AND SL81 MESH, MANUFACTURED TO ACCOMODATE TERRA FIRMA E400 PIT LID AND FRAME.
CONCRETE: CLASS N32 MINIMUM COMPRESSIVE STRENGTH 32 MPa
SL81 PLACED CENTRALLY

JUNCTION BOX (1200 x 1200)

NOTES:

1. REFER TO CCS STORMWATER PIT INSTALLATION DETAIL (M1591) FOR MINIMUM EXCAVATION, BEDDING AND BACKFILL REQUIREMENTS.



DRAWING FILE LOCATION
T:\AUTOCAD BLOCKS\2010+VJB-1200 (M1267).dwg
COORDINATOR DESIGN
B. MORIAS
16.11.23

EDITED
G.FERTEKLIS
16.11.23
DRAWN
J. CURSARO
18.03.11
DESIGNED
J. CURSARO
18.03.11

STANDARD DETAIL
JUNCTION BOX
1200 x 1200
SCALE AS SHOWN

CITY OF CHARLES STURT	
SHEET	
1	of 1
TRIM No.	12/31079
DRAWING No.	M1267
	D