

**PLAN**  
NOT TO SCALE

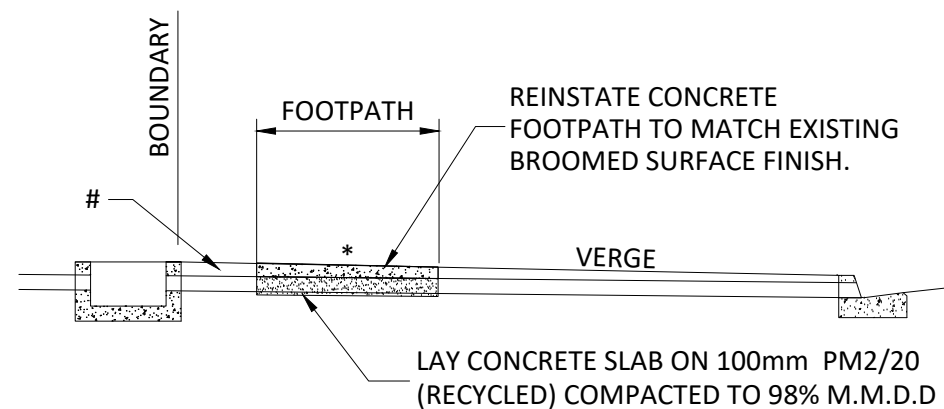

- \* IDEAL MINIMUM SLOPE SHALL BE 1% WHERE ACHIEVABLE.
- # MINIMUM 100mm CLEARANCE TO TOP OF STORMWATER PIPE.  
IF THIS CANNOT BE ACHIEVED, CONTACT CCS ENGINEERING  
PROJECT OFFICER ON 84081111.

**SECTION**  
NOT TO SCALE

TRIM PIPE TO FIT INTO 1000  
CORE IN KERB. GAP TO BE  
SEALED WITH "PARFIX ROOF,  
GUTTER & CONCRETE SEALANT"  
(OR SIMILAR APPROVED) BOTH  
FRONT & BACK

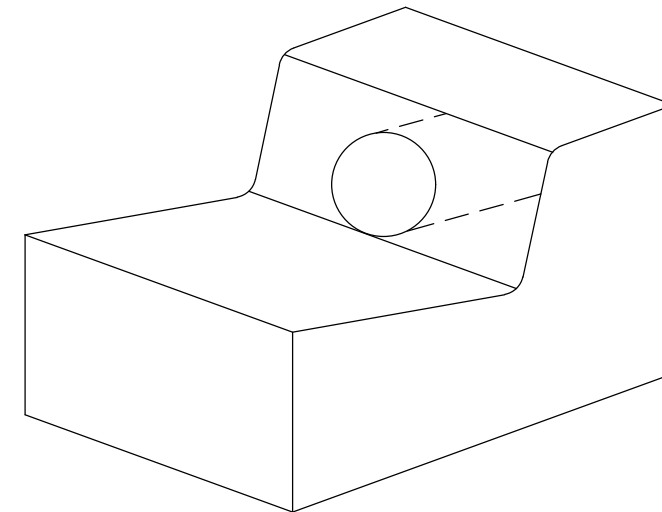

**DRAINAGE OUTLET KERB INSERT  
(UPRIGHT KERB)**

NOT TO SCALE

**NOTES:**

1. THE ONUS IS ON THE OWNER OR THEIR REPRESENTATIVE TO LOCATE PUBLIC UTILITY SERVICES WITHIN THE FOOTPATH PRIOR TO THE COMMENCEMENT OF WORK. ANY COSTS INCURRED IN REPAIRING DAMAGES TO SERVICES WILL BE AT THE EXPENSE OF THE PERSON CAUSING THE DAMAGE.
2. THIS DRAINAGE OUTLET SHALL BE USED FOR KERB & GUTTER 150mm OR HIGHER.
3. FOR 100mm HIGH KERB DRAINAGE OUTLET, REFER TO CCS STANDARD DRAWING M1577.

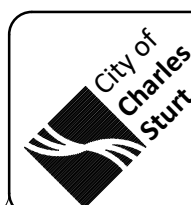

DRAWING FILE  
LOCATION  
T:\AUTOCAD  
BLOCKS\2010\STORMWATER  
DRAINAGE OUTLET - TYPE 1  
(M1578).dwg  
COORDINATOR  
DESIGN  
B. MORIAS  
21.11.23

EDITED  
G.FERTEKLIS  
21.11.23  
DRAWN  
J. CURSARO  
23.07.14  
DESIGNED  
B. MORIAS  
19.09.06

STANDARD DETAIL  
**STORMWATER DRAINAGE  
OUTLET (TYPE 1)**

SCALE AS SHOWN

CITY OF CHARLES STURT  
SHEET  
**1** of **1**  
TRIM No.  
**23/12402**  
DRAWING No.  
**M1578**