

TRANSVERSE CONTRACTION JOINT

SCALE 1 : 10

- @ 2m MAX. CENTRES FOR 1.5m WIDE PATH.

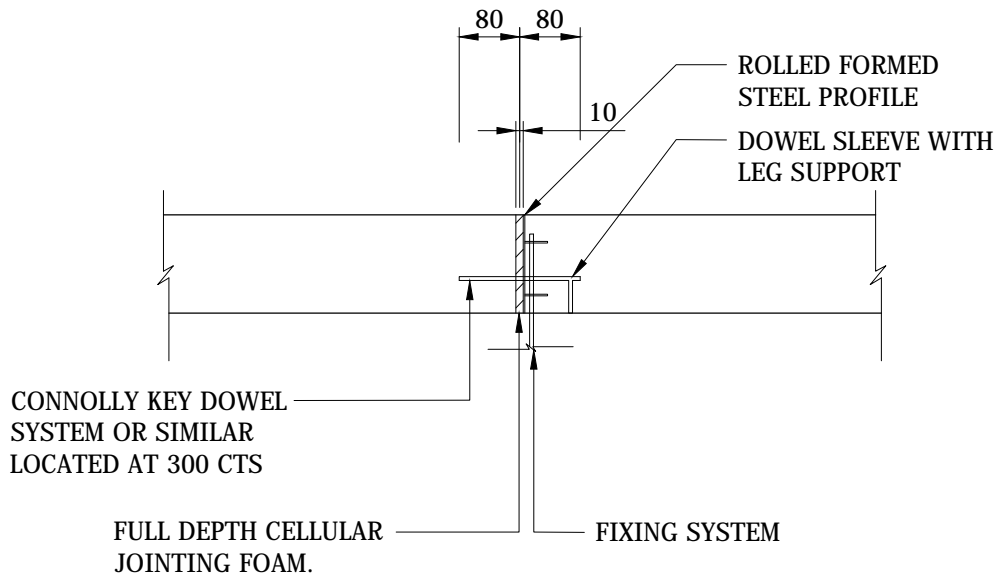

CONNOLLY KEY DOWEL SYSTEM OR SIMILAR LOCATED AT 300 CTS

FULL DEPTH CELLULAR JOINTING FOAM. FIXING SYSTEM

EXPANSION/CONTRACTION JOINT

SCALE 1 : 10

- @ 6m MAX. CENTRES FOR 1.5m WIDE PATH.

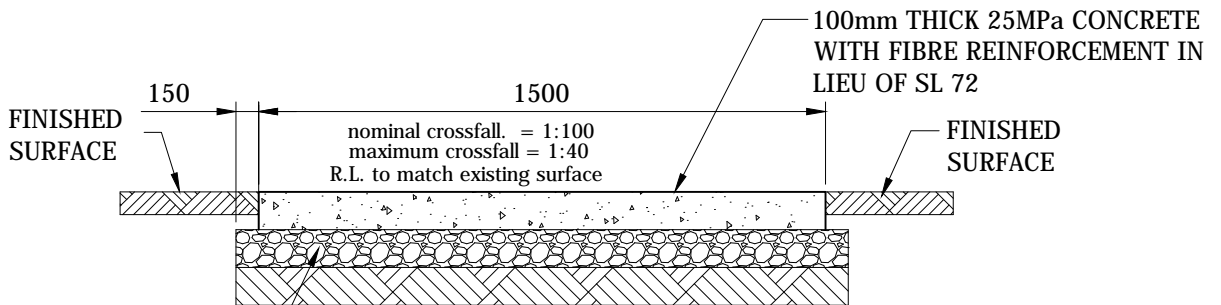

100mm PM2/20 (RECYCLED OR QUARRIED) COMPACTED TO 98% M.D.D MODIFIED

CONCRETE FOOTPATH

SCALE 1 : 20

(Note maximum longitudinal grade to be 1:33)

NOTE:

CONCRETE TO BE 25MPa WITH 14mm AGGREGATE



DRAWING FILE LOCATION
T:\AUTOCAD BLOCKS\2010+FOOTPATH - CONCRETE WITH REIO.dwg

COORDINATOR DESIGN
B. MORIAS
04.12.14

EDITED
J. CURSARO
04.12.14
DRAWN
J. CURSARO
25.06.14
DESIGNED
J. CURSARO
25.06.14

STANDARD DETAILS

CONCRETE FOOTPATH WITH REINFORCEMENT

SCALE AS SHOWN

CITY OF CHARLES STURT

SHEET	1	of	1
TRIM No.	14/176626		
DRAWING No.	M.1495		1